



WATERPROOFING

COLPHENE® 3000 FOUNDATIONS



SELF-ADHERED WATERPROOFING MEMBRANE FOR FOUNDATIONS

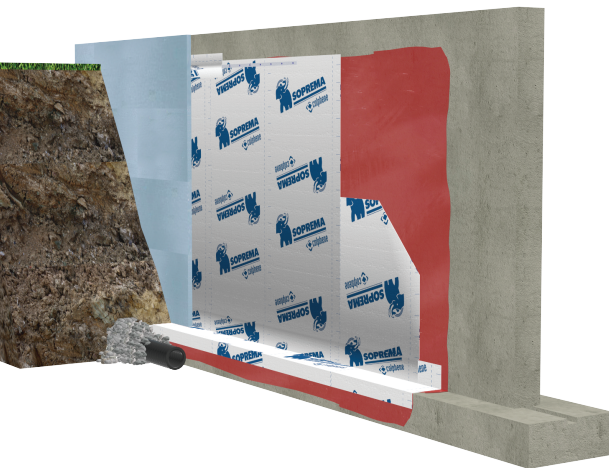

COLPHENE 3000 self-adhered membrane is made from the most reliable SBS modified bitumen in the industry and has a tri-laminated woven polyethylene facer. It is extremely flexible, easy to handle, and fits easily around the sharp contours and angles of concrete footings and foundations. COLPHENE 3000 is the perfect solution for below grade and foundation wall waterproofing.

- Superior flexibility
- Puncture resistant with high tensile strength
- Consistent thickness

SURFACE PREPARATION

COLPHENE 3000 must always be installed on clean, dry, solid substrates, which have been primed before application with ELASTOCOL Stick, ELASTOCOL Stick Zero or ELASTOCOL Stick H₂O.

COMPLEMENTARY PRODUCTS

ELASTOCOL STICK, ELASTOCOL STICK ZERO & ELASTOCOL STICK H₂O

Used to prepare surfaces before the installation of self-adhered membranes

SOPRAMASTIC SPI

Ideal complement to bituminous waterproofing membranes as a joint filler and caulking material.

COLPHENE 3000	
THICKNESS	60 mils (1.5 mm)
DIMENSIONS	39 in x 61 ft (1m x 18.6m)
SURFACE	Tri-laminated woven polyethylene
UNDERFACE	Silicone release film



SOPREMA.US • 1.800.356.3521

SOPREMA.CA • 1.877.MAMMOUTH

INSTALLATION INSTRUCTIONS

1



Prime the substrate with ELASTOCOL Stick, ELASTOCOL Stick Zero or ELASTOCOL Stick H₂O.

2



Peel back the top part of the silicone release film. Adhere COLPHENE 3000 to the substrate, making sure the membrane is well aligned.

3



Gradually peel back the remaining silicone release film, making sure the membrane is completely adhered.

The use of a hand roller is required to remove air pockets.

4



Use SOPRAMASTIC SP1 to seal details and critical areas.

The use of a protection or drainage board is recommended before backfilling to ensure the integrity of the waterproofing membrane.

5



Completed waterproofing project.

If you have any questions about this product or its installation, please contact your SOPREMA representative.



SOPREMA.US • 1.800.356.3521

SOPREMA.CA • 1.877.MAMMOUTH

SS10051 - REV. 0717