



COLPHENE BSW V

COLPHENE BSW V is a pre-applied membrane designed for vertical blindside waterproofing applications. It is composed of high performance SBS modified bitumen combined with an ultra-high strength composite reinforcement. The surface is sanded and the underside is self-adhesive with a silicone release film. COLPHENE BSW V is provided with DUO SELVEDGE technology, allowing for the welding of longitudinal selvages with a torch or hot air gun.

- High performance composite
- May be applied in most weather conditions
- Increased resistance to hydrostatic pressure
- Superior puncture and tear resistance
- Excellent adhesion to cast-in-place concrete
- Vertical application
- Superior dimensional stability



COLPHENE BSW H

COLPHENE BSW H is a pre-applied membrane designed for horizontal blind side waterproofing applications. It is composed of high performance SBS modified bitumen combined with a non-woven polyester reinforcement. The surface is sanded and the undersurface is protected with a thermofusible plastic film. Its unique design, including patented DUO SELVEDGE technology, allows the welding of longitudinal side laps using a torch or hot air gun.

- Excellent adhesion to cast-in-place concrete
- Increased resistance to hydrostatic pressure
- Superior puncture and tear resistance
- No temperature limitations
- Horizontal application
- Also used as reinforcement for tie backs

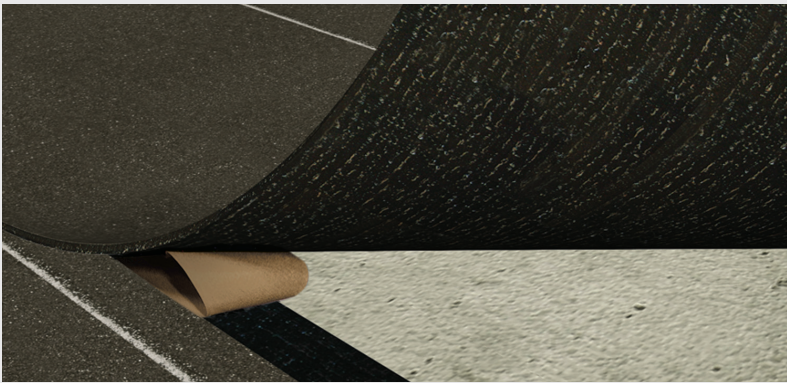

DUO SELVEDGE TECHNOLOGY

Patented DUO SELVEDGE technology provides safe and waterproof attachment.

- Protects the system components beneath the base ply during heat welding
- Immediately bonded
- Partially self-adhered lap (60% of the side lap) leaving only 40% to be heat welded
- Provides proven waterproof protection of heat welded seams

INNOVATION SINCE 1908

SOPREMA has developed around the idea that the quality, durability and reliability of materials must match builders' ambitions and expectations. For more than 100 years, SOPREMA has been using its expertise to develop a variety of high-end products that meet or exceed all the requirements of the construction field.

ROOFS WALLS FOUNDATIONS PARKING DECKS BRIDGES ADDITIONAL APPLICATIONS



WATERPROOFING



INSULATION



VEGETATED SOLUTIONS



SOUNDPROOFING



RELATED PRODUCTS

SOPREMA is an international manufacturer specializing in the production of innovative products for waterproofing, insulation, soundproofing as well as vegetated solutions for the roofing building envelope and civil engineering sectors.

SOPREMA.US • 1.800.356.3521 SOPREMA.CA • 1.877.MAMMOUTH



WATERPROOFING

COLPHENE® BSW
BLINDSIDE WATERPROOFING

FOUNDATIONS





COLPHENE® BSW

THE SOLUTION FOR FOUNDATIONS IN DENSILY POPULATED AREAS

COLPHENE BSW is a fully reinforced pre-applied membrane system designed for horizontal and vertical blind side waterproofing applications. Its unique design offers the possibility to use it where nearby buildings limit access and excavation.

ADVANTAGES

- Excellent adhesion to poured concrete
- Resistant to hydrostatic pressure
- Superior resistance to tears and punctures
- COLPHENE BSW laps are heat-welded creating monolithic joints; no tape needed
- Resistant to chemicals
- Non-permeable to vapor and gas

INNOVATION

AT YOUR SERVICE, FROM DESIGN TO COMPLETION

The COLPHENE BSW membranes are composed of a select blend of high performance SBS modified bitumen combined with an ultra high strength reinforcement and specially designed sanded top surface. This specifically formulated surface softens slightly as the concrete starts to cure, releasing heat. This contributes to the promotion of adhesion of the membrane to the concrete and prevents the ingress or migration of water around the structure. Benefiting from the effects of the exothermic reaction that occurs during the curing process of the concrete, the COLPHENE BSW system has superior adhesion to the concrete due to these chemical and mechanical bonds. This innovative technology allows

the system to enjoy a continuous and homogenous bond to structural concrete, exceptional peel strength and superior mechanical properties. Patented DUO SELVEDGE technology ensures that the side lap is instantly watertight, as well as providing additional watertightness during phased construction.



SUCCESS STORY

Denver Union Station
Denver, Colorado

Denver Union Station is a unique project that brought together many different transportation modes to create a truly special place in Denver that connects the city, region and state in one central location. Denver Union Station has a sprawling new train shed, a light-rail terminal, underground bus terminal, pedestrian walkway, extended mall shuttle and a renovated historic station. In 2011, SOPREMA met the challenges of waterproofing the building envelope with the COLPHENE BSW system to ensure a seamless watertight solution. Over 170,000 sq ft of COLPHENE BSW was used as a waterproofing membrane.



FULL SYSTEM WITH ACCESSORIES

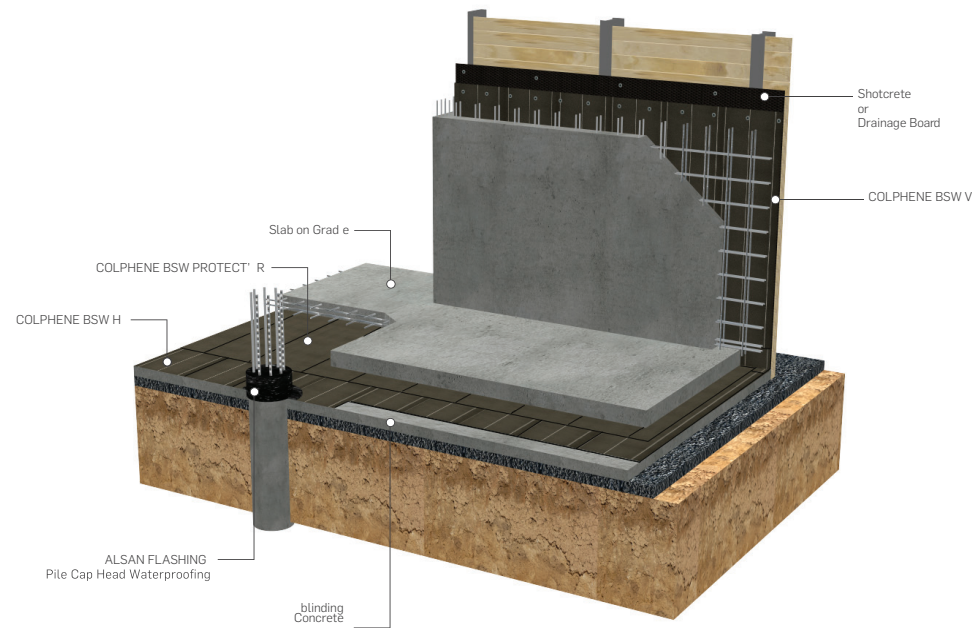

SOPRADRAIN®

High-density drainage panel with a factory-laminated geo-textile filter fabric over blinding on vertical surface before installation of COLPHENE BSW.

BENEFITS

- Promotes better flow toward drains
- Reduces hydrostatic pressure
- Provides a smooth surface for application of the COLPHENE BSW V



COLPHENE BSW PROTECT'R

COLPHENE BSW PROTECT'R is a fully reinforced protection sheet specially designed for horizontal blind side waterproofing applications. It is composed of high performance SBS modified bitumen combined with an ultra-high strength composite reinforcement.

BENEFITS

- Protects the COLPHENE BSW H from damage due to foot traffic, rebar installation and material storage on its surface.



ALSAN® FLASHING*

Polyurethane/bitumen liquid waterproofing membrane used in combination with ALSAN Polyfleece for sealing around penetrations.



* Available in 1 GAL (3.78 L) or 5 GAL (19 L)